

EQUESTRIAN SPRINGS PRICE LIST

3-21-19

"Ocala's Most Beautiful Gated Horse & Nature Community"

Where you can build your dream country estate home or mini horse farm

Lot	Acres	\$ / Acre		Price
1	2.8	\$ 13,387	\$	37,350
2	5.0	\$ 14,098	\$	70,350
4	2.8	\$ 13,399	\$	37,650
6	3.0	\$ 13,378	\$	39,600
7	3.8	\$ 13,800	\$	51,750
9	3.6	\$ 13,747	\$	49,350
10	7.6	\$ 9,405	\$	71,100
12	9.4	\$ 9,523	\$	89,900
14	3.4	\$ 13,665	\$	46,050
19 Estate Sale (reduced)	2.6	\$ 12,893	\$	33,650
20 Estate Sale (reduced)	4.0	\$ 14,090	\$	56,500
21 Estate Sale	9.0			SOLD
22 Estate Sale (reduced)	3.5	\$ 10,580	\$	36,500
23	2.9	\$ 13,421	\$	38,250
24	2.9			SOLD
26	4.2	\$ 13,916	\$	57,750
27	2.9	\$ 13,469	\$	39,600

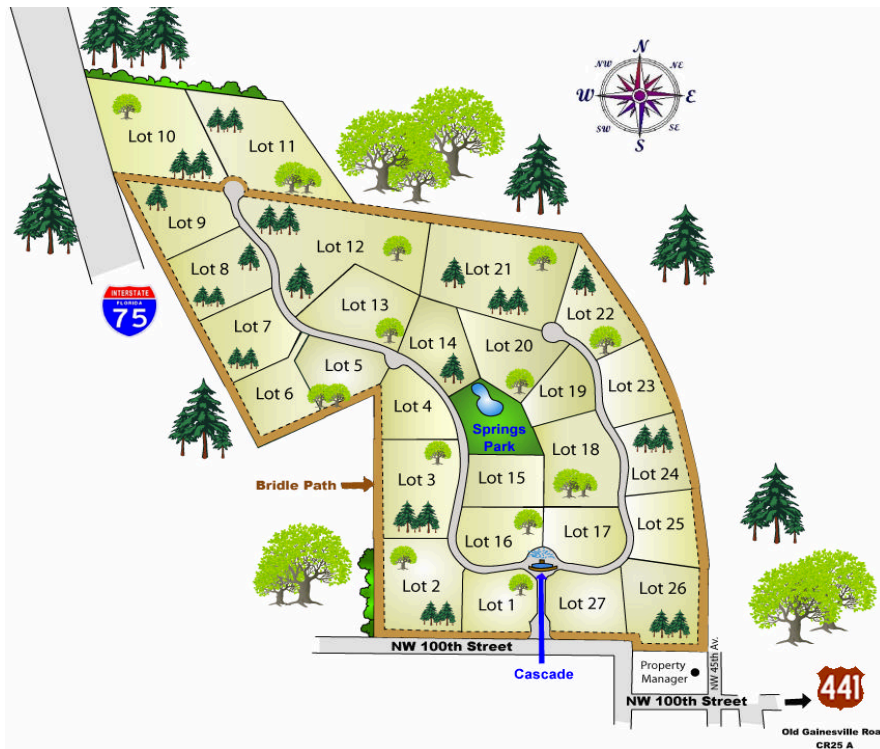

Equestrian Springs is located in NW Marion County at
4701 NW 100th Street, Ocala, FL 34482

www.EquestrianSprings.com

info@EquestrianSprings.com

To view, call/text Hellena at (352) 875-8156