

5-Sep-20

"Ocala's Most Beautiful Gated Horse & Nature Community"
Where you can build your dream estate home or mini horse farm

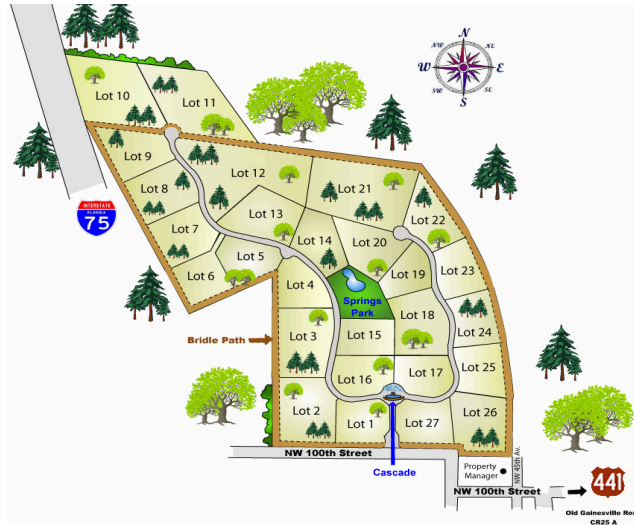

Equestrian Springs is located in NW Marion County at
 4701 NW 100th Street, Ocala, FL 34482

www.EquestrianSprings.com

info@EquestrianSprings.com

To view, call/text Hellena at (352) 875-8156

Lot	Acres	\$ / Acre	Price 9-5-20
1	2.79		SOLD
2	4.99		SOLD
3	2.95		SOLD
4	2.81		SOLD
5	4.16		SOLD
6	2.96		SOLD
7	3.75		SOLD
8	5.07		SOLD
9	3.59		SOLD
10	7.56	\$ 9,405	\$ 71,100
11	7.09		Resale ASK FOR PRICING
12	9.44		SOLD
13	4.31		SOLD
14	3.37		SOLD
15	2.90		SOLD
16	3.09		SOLD
17	2.97		SOLD
18	4.67		SOLD
19	2.61		SOLD
20	4.01		SOLD
21	9.03		SOLD
22	3.45		SOLD
23	2.85		SOLD
24	2.90		SOLD
25	3.25		SOLD
26	4.15	\$ 13,000	\$ 53,950
27	2.94		SOLD